

SHEARLOCK



Series SH

Shearlocks are the ideal solution for **glass, swing and sliding doors**. They combine magnetic and mechanical force generating a massive holding force. Shearlocks can be timed and connected to fire detectors, alarms, access control systems, emergency exit buttons, etc. If a locking defect happens after 5 attempts, the shearlock emits a warning sound until the system is reset.

Example of use:

A thief tries to escape through an emergency door where a panic bar and a shearlock are installed. When the thief pushes the panic bar, the door will still be locked by the shearlock for the programmed time, and a warning signal will be sent to the store's control center. If the system is equipped with an acoustic alarm, it will be ringing for the time the shearlock is programmed to, forcing the thief to drop the goods.

Technical features

- 15.000 N holding force
- Electronic protection
- Timer: adjustable from 0 to 25 seconds for both locking (T1) and unlocking (T2)
- Maximum distance between parts: 3 mm
Minimum distance between glasses: 6,5 mm
- 3 colours LED indicator (opened/closed/malfunction)
- Power from 10 to 36V DC (automatic switch)
- Operating temperature: from -14 to +40 °C
- Consumption at 12V DC: 2A (start up) then 0,5A (operating)
- Auxiliary relay: max. 1A at 24V DC
- Guaranteed 3 years

References and features

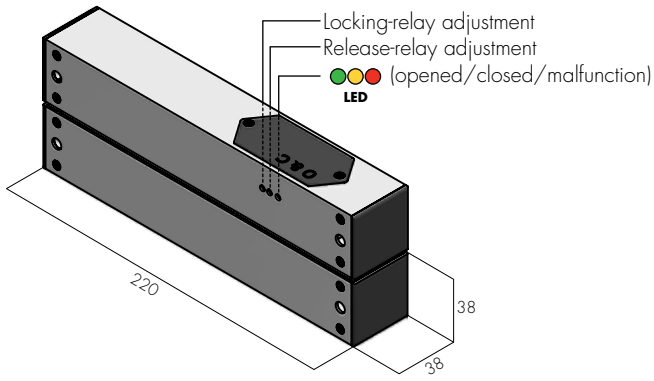

SHEARLOCK SH 100
(rim installation)

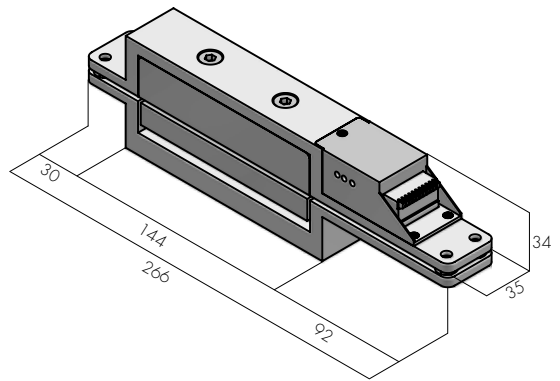

SHEARLOCK SH 200
(mortise installation)

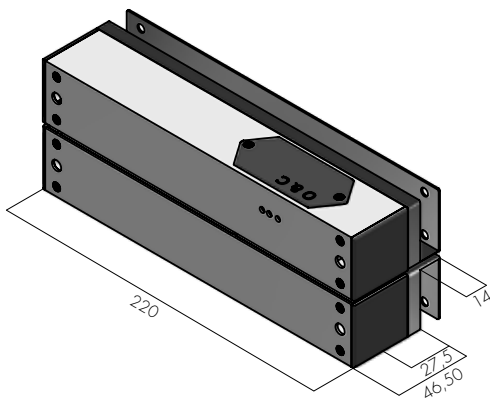

SHEARLOCK SH 300
(glass/glass installation)

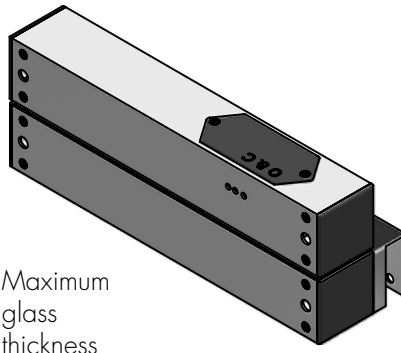

SHEARLOCK SH 400
(rim/glass installation)

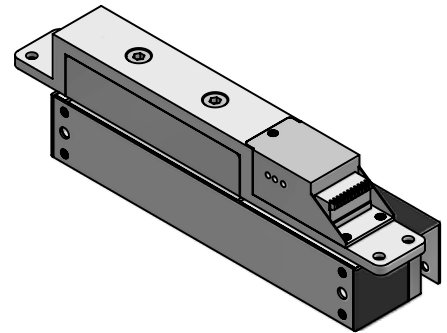

SHEARLOCK SH 500
(mortise/glass installation)

Installation example

