



ARMOURED

Series 9R & 9L

These electric strikes have been especially designed for armoured doors secured by **multipoint locks** where the separation between the latch and the first bolt is only 5mm.

DC models are equipped with electronic protection in order to prevent damages to your access control system. This also represents an advantage for the installer as the connection is not polarized.

Featuring a wide variety of functions and voltages, these strikes quickly unlock standard doors through low power consumption.

Technical features

- Max. side-load on AC: 160 N
Max. side-load on DC: 10 N
- Break-in resistance: 7.000 N
- Operating temperature range: -15 °C / +40 °C
- Housing: Zamak
Keeper: Zamak
- Patented coil-fastening system
- Guaranteed 3 years
- Complies with 2004/108/CE (EN 55014)
- Corrosion resistant according to UNI ISO 9227

Coil features

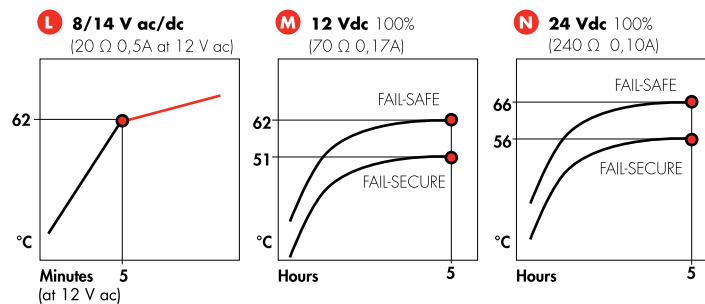

Personalized coils upon request

References and features

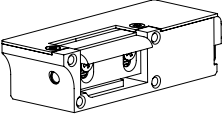
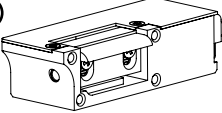
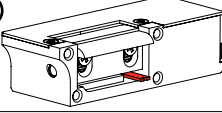
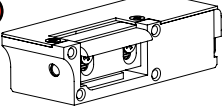
		Adjustable keeper	Side-load	Electronic protection	Voltage	References DIN right add faceplate	References DIN left add faceplate
 <p>Fail-secure</p>		●	●		8-14 V ac/dc	9R0.1.00.L	9L0.1.00.L
		●		●	12 V dc	9R0.1.00.M	9L0.1.00.M
		●		●	24 V dc	9R0.1.00.N	9L0.1.00.N
 <p>Internal Hold-open</p>		●	●		9-14 V ac/dc	9R2A.1.00.L	9L2A.1.00.L
 <p>Internal Hold-open with mechanical unlocking</p>		●	●		9-14 V ac/dc	9R3A.1.00.L	9L3A.1.00.L
 <p>Fail-safe</p>		●		●	12 V dc	9R4.1.00.M	9L4.1.00.M
		●		●	24 V dc	9R4.1.00.N	9L4.1.00.N

Recommended Faceplates

LONG

- 60 Inox
- 70 Inox

Deep adjustable keeper
Supplied upon request

AK3

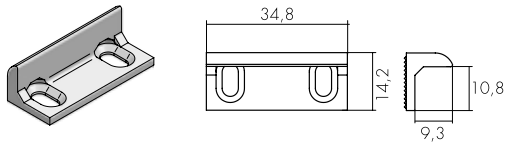

Dimensions

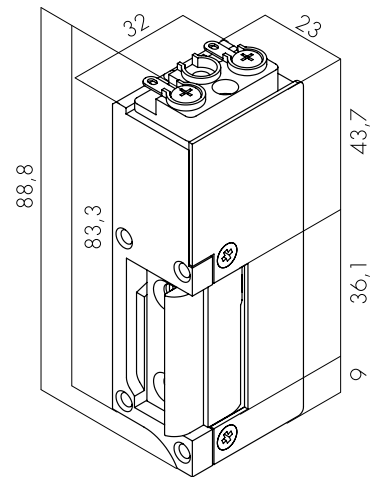

Keeper's adjustability: 3 mm